

# MULTIPLE SMALL HALOGEN MR16

## SPECIFICATION SHEET

PAGE: 1 OF 2

Project name: \_\_\_\_\_

Type: \_\_\_\_\_



### General information

**Source:** MR16 halogen low voltage GU5.3 base (not included).  
Max 50W or 35W with insulated ceiling housing.

**Optics:** Each optical assembly is adjustable 45° in all axes. A wide range of optical accessories is available.

**Body:** Die-cast aluminum optical assembly and frame w/ black steel housing, connection box and fasteners.

**Electrical:** High efficiency low voltage electronic transformer 120V or 277V.

**Dimming:** Standard power supply compatible with ELV dimming (120V only).

**Mounting:** 22 gauge galvanized sheet metal. Multiple is supplied with three types of mountings: open ceiling frame (8110), insulated ceiling housing (8110I) or Chicago plenum rated insulated ceiling housing (8110A).

**Finish:** White RAL9003 or gray RAL9006 painted finish.  
RAL custom color available upon request.

**Weight:** 5lbs (2.25kg)

**Warranty:** 1 years limited warranty.

**Certification:** cULus listed.

**Ratings:** Damp location, IP20.

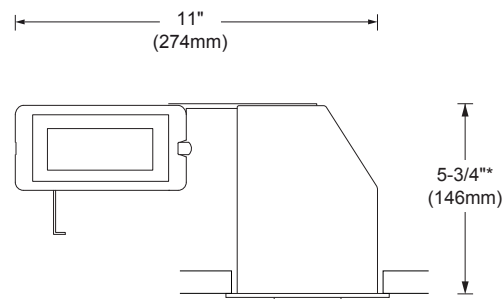

**SIDE VIEW**

\*For minimum clearance height see mounting info on page 3.

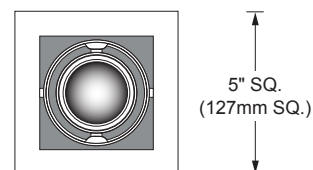

**BOTTOM VIEW**

# MULTIPLE SMALL HALOGEN MR16

## SPECIFICATION SHEET

PAGE: 2 OF 2

Project name: \_\_\_\_\_

Type: \_\_\_\_\_

### ACCESSORIES (TO BE ORDERED SEPARATELY)

\*Maximum of 1 accessory by optical assembly.

- ☐ **8050** - Frosted glass 
- ☐ **8658-05** - Red glass
- ☐ **8658-06** - Yellow glass
- ☐ **8658-09** - Sky blue glass

\* can only be install with the antiglare accessory

- ☐ **8675** - Louvre 

\* can only be install with the antiglare accessory

- ☐ **8111** - Visor 

- ☐ **8113** - Antiglare 

### MOUNTING (INCLUDED)

#### HOUSING FOR OPEN CEILING

- ☐ **MUL-110C-KIT** - Open ceiling frame

**Dimensions:** 8-5/8" x 15-5/8" (219mm x 397mm)

**Hanger bars:** 14 1/4" to 26" (362mm x 660mm)

**Total weight:** 5lbs (2.25kg)

**Clearance:** 5-3/4" (146mm)

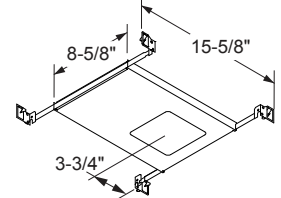

#### HOUSING FOR INSULATED CEILING

**8110I:** Standard housing suitable for insulated ceiling

- ☐ **MI1-T** - Standard version

**8110A:** Chicago plenum rated housing suitable for insulated ceiling

- ☐ **MI1A-T** - Standard version

**Dimensions:** 12-3/4" x 14-3/8", h:6-3/4" (324mm x 365mm, h:171mm)

**Hanger bars:** 14 1/4" to 26" (362mm x 660mm)

**Total weight:** TBC

**Clearance:** 6-3/4" (171mm)

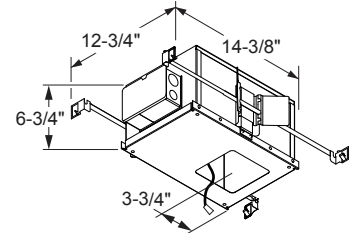

### INSTALLATION INFO

**Ceiling thickness:** Min: 1/8" (3mm), Max 1-3/8" (35mm)

**Cut-out dimension:** 4-1/2" x 4-1/2" (114mm x 114mm)

Mounting	Minimum clearance height*
<b>MUL-110C-KIT</b>	6" (152mm)
<b>MI1-T</b>	6-3/4" (171mm)
<b>MI1A-T</b>	6-3/4" (171mm)

\* At installation

### ORDERING INFO

MODEL	VOLTAGE	FINISH	MOUNTING
<input type="radio"/> <b>8110</b> <input type="radio"/> <b>8110I</b> <input type="radio"/> <b>8110A</b>	<input type="radio"/> <b>120</b> - 120V <input type="radio"/> <b>277</b> - 277V	<input type="radio"/> <b>01</b> - WHITE <input type="radio"/> <b>10</b> - GRAY	

DUE TO CONTINUOUS IMPROVEMENTS, THE INFORMATION HEREIN MAY BE CHANGED WITHOUT NOTICE.

LAST UPDATE: APRIL 22, 2015

MGD- R3

# SISTEMALUX



9320 Boul. St-Laurent,  
suite 100, Montréal (Québec)  
Canada H2N 1N7  
P.: 514.523.1339 F.: 514.525.6107  
www.sistemalux.com